

ELEVATIONS

Elevation 1 - Outside View (Scale 1:20)

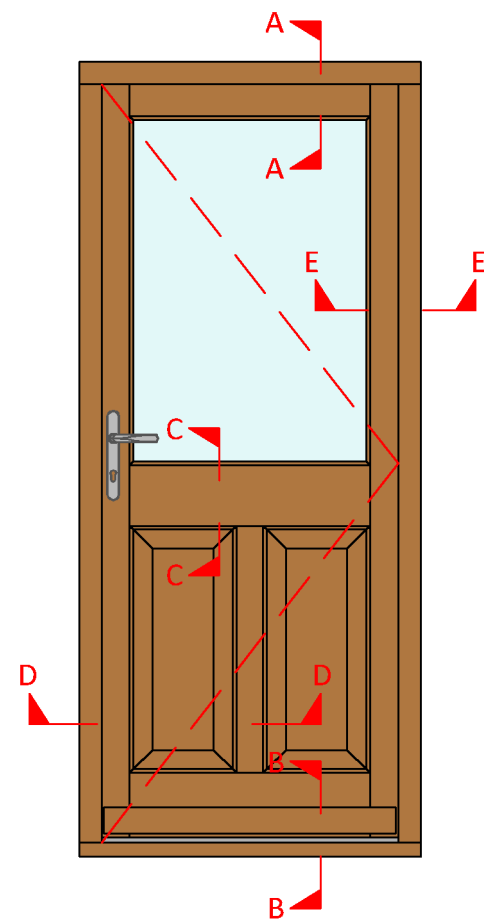

Elevation 2 - Inside View (Scale 1:20)

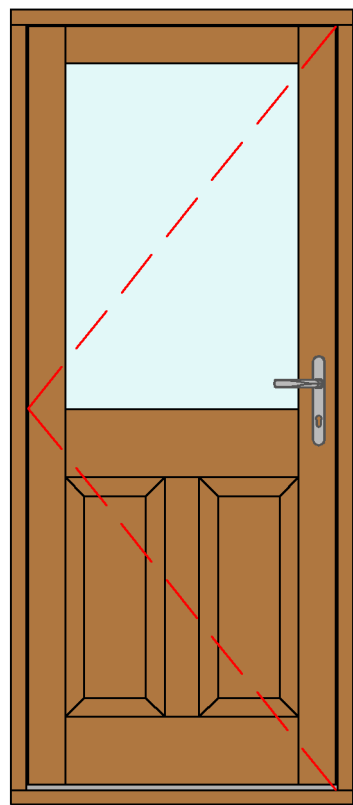

SECTIONS

Section D-D - Jamb and Vertical Rail (Scale 1:2)

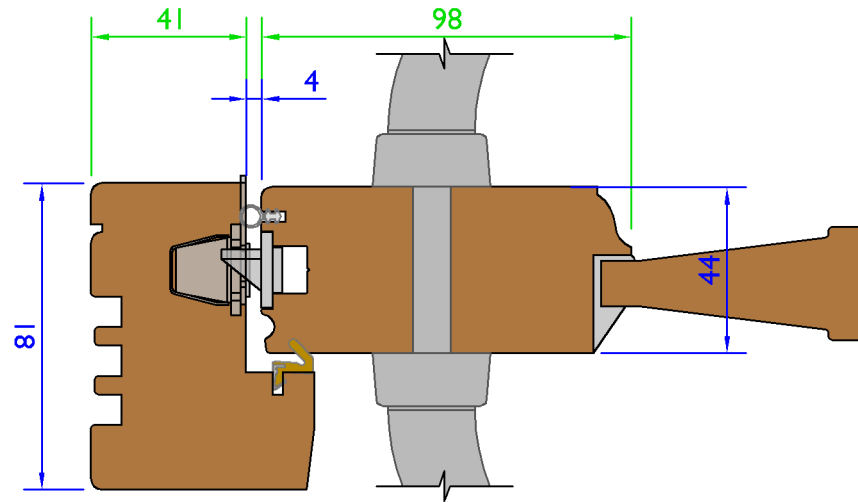

Section B-B - Cill Detail (Scale 1:2)

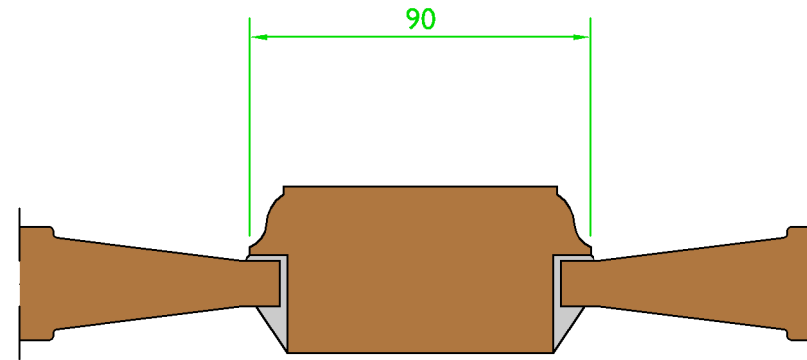
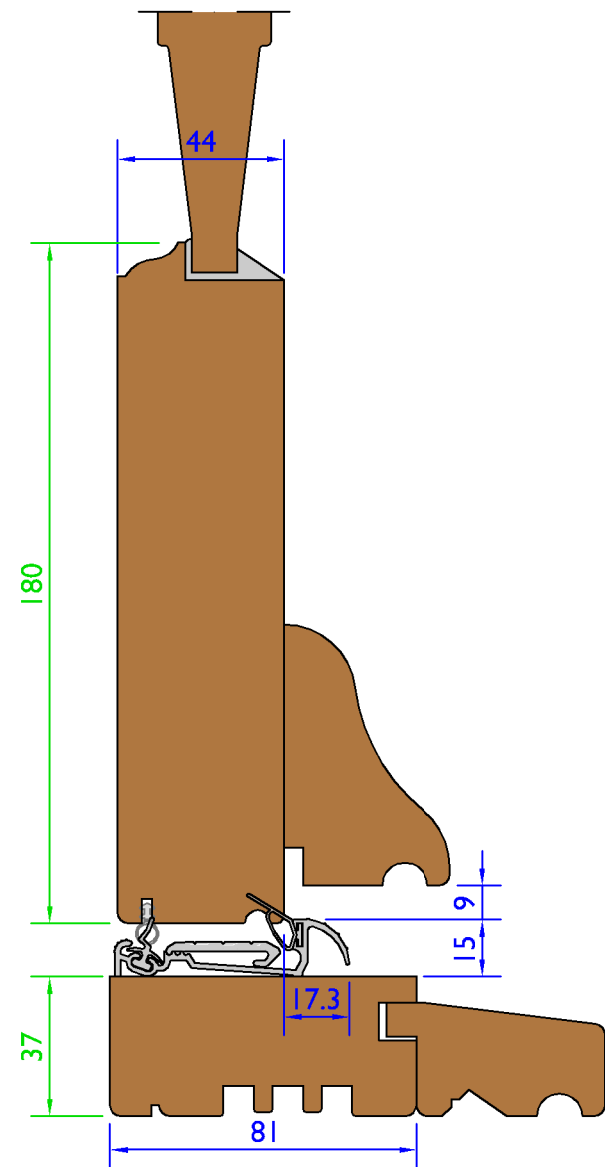

Section C-C - Midrail (Scale 1:2)

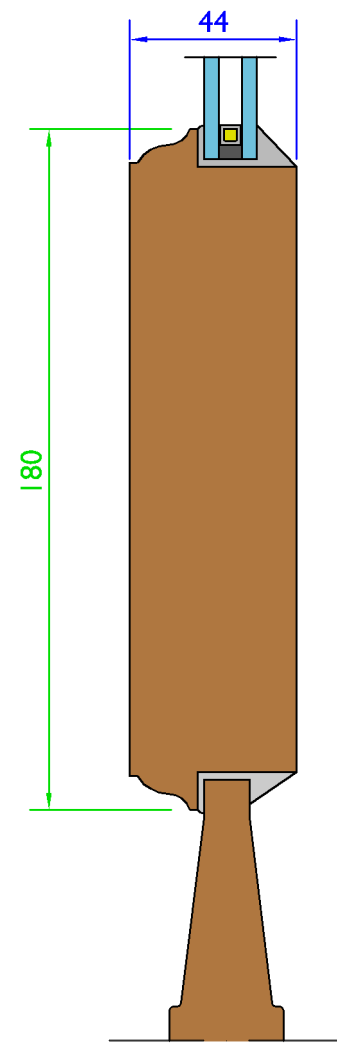

Section A-A - Head Detail (Scale 1:2)

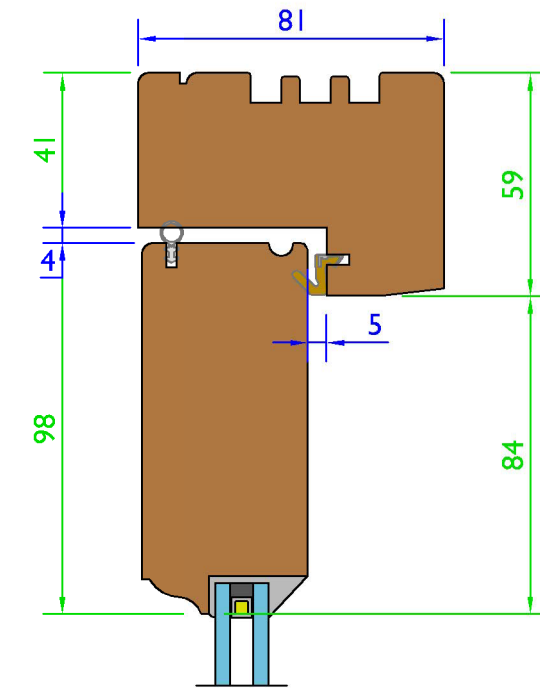

Section E-E Hinge Detail - (Scale 1:2)

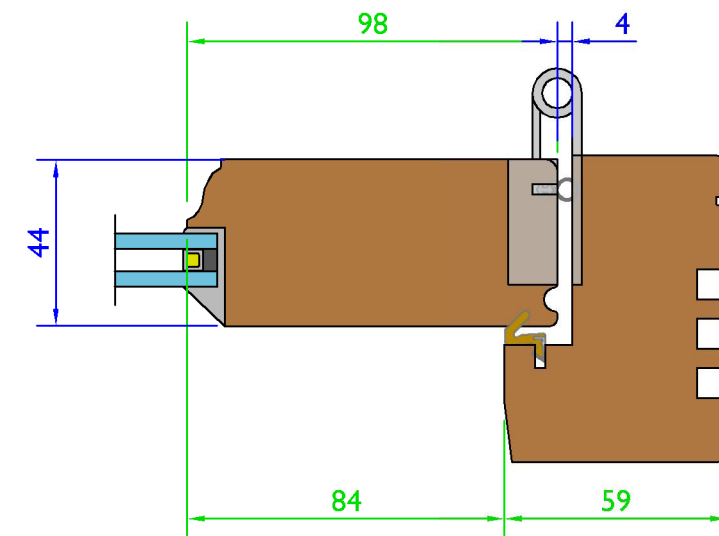

Variable Dimensions
(Dim shown is usually min)

Fixed Dimensions

Tolerances: All tolerances are to George Barnsdale Standard Tolerance definitions (see supporting document for more detail) unless stated on the drawing.
© George Barnsdale & Sons Ltd. All rights reserved. No part of this drawing may be reproduced without the permission of George Barnsdale & Son Ltd.

System: H-DS2-81-44		
Title: Historic - Inward Opening Doorset (44mm)		
Scale:	As Shown	Rev No: A
Drawn By:	LH	Date: 15-Mar-18
		Sheet No: 1
		Status: Released

GEORGE BARNSDALE
Est. 1884
High Street, Donington, Spalding, Lincs, PE11 4TA
01775 823000
www.georgebarnsdale.co.uk

ELEVATIONS
Type L204 - Outside View -
(Scale 1:40)

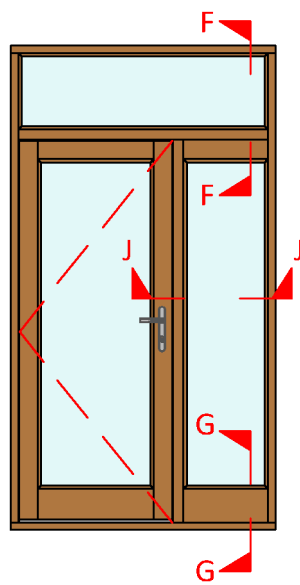

Stable Door - Outside View -
(Scale 1:40)

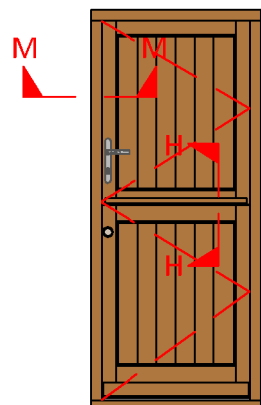

SECTIONS
Section J-J - (Scale 1:2)

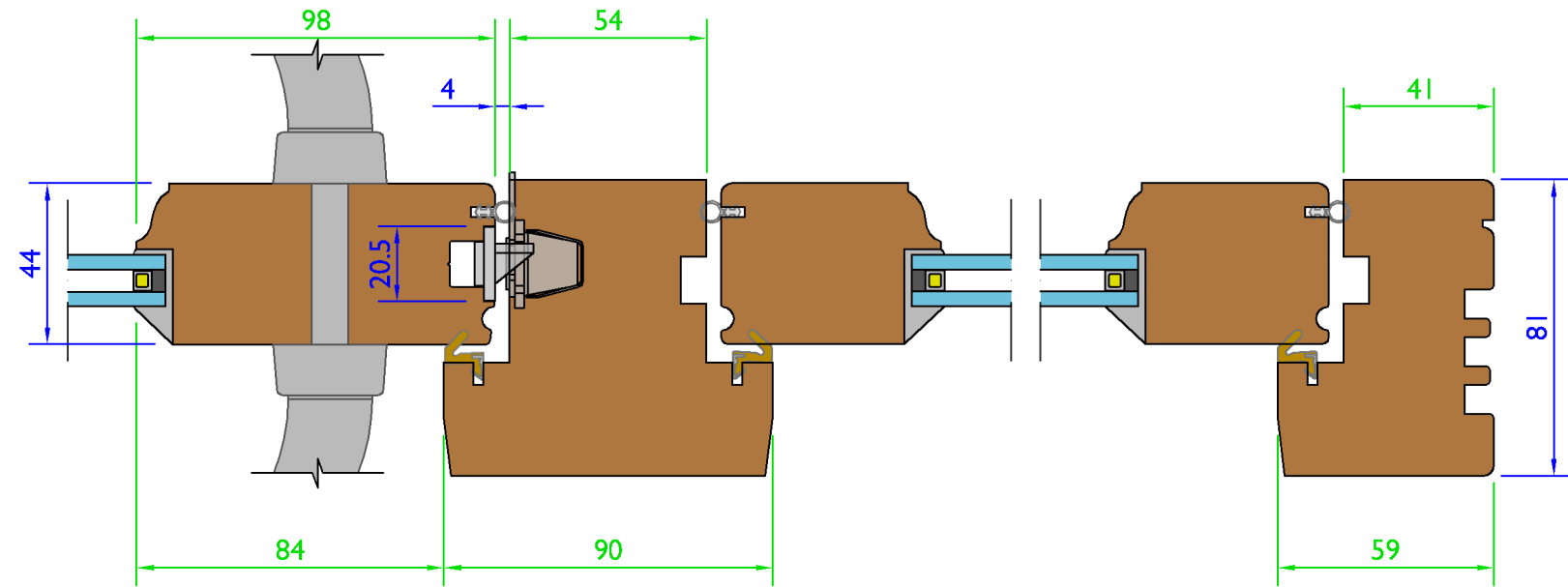

Section F-F - (Scale 1:2)

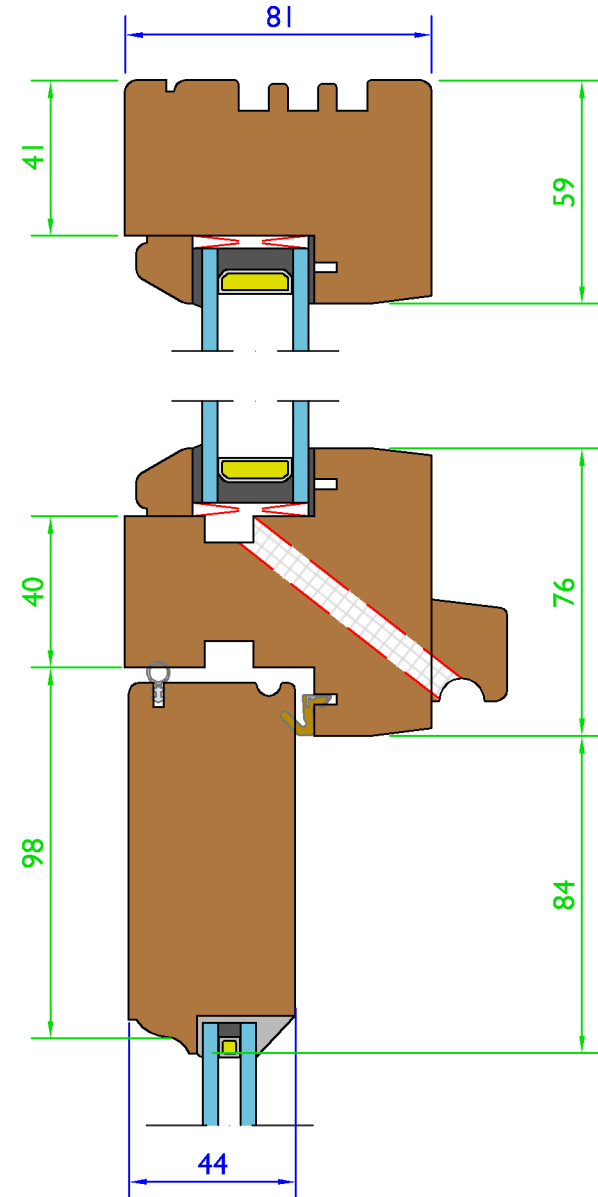

Section G-G - (Scale 1:2)

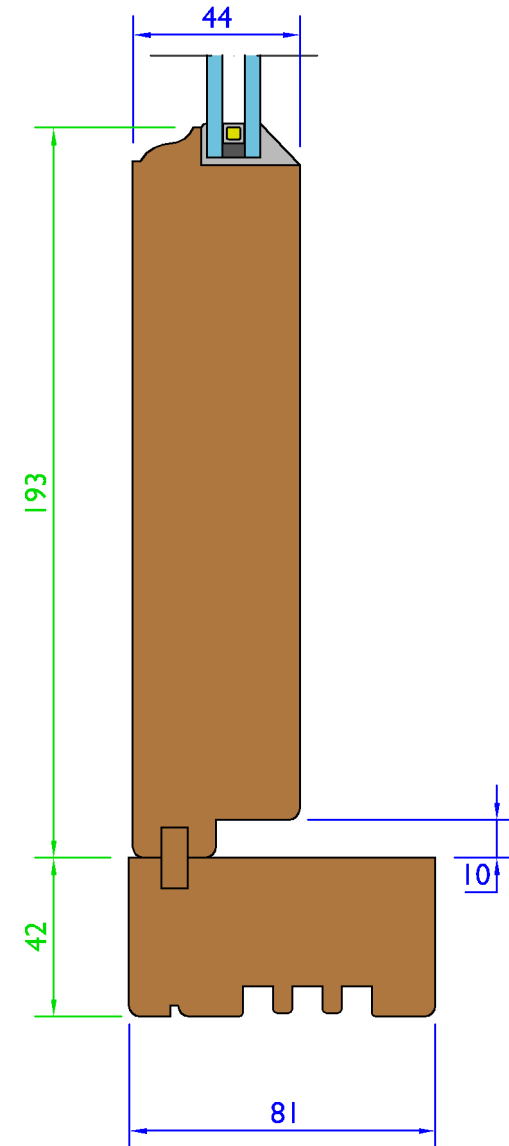

Stable Door Meeting H-H - (Scale 1:2)

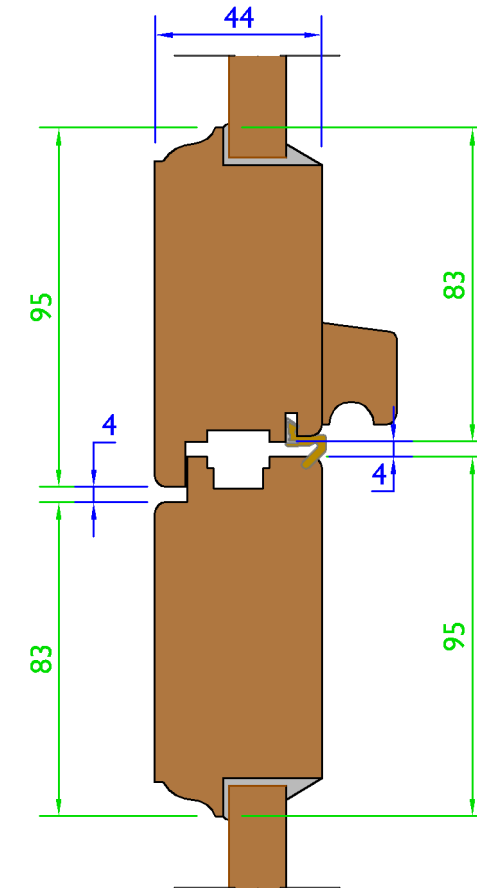

Section M-M Stable Door Lock and Frame -
(Scale 1:2)

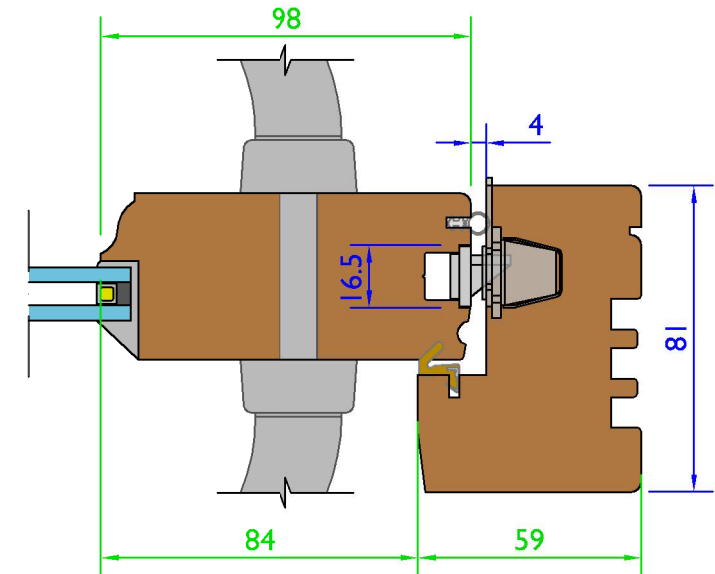

 Drainage System

 Variable Dimensions
(Dim shown is usually min)

 Fixed Dimensions

Tolerances: All tolerances are to George Barnsdale Standard Tolerance definitions (see supporting document for more detail) unless stated on the drawing.
© George Barnsdal: & Sons Ltd. All rights reserved. No part of this drawing may be reproduced without the permission of George Barnsdale & Son Ltd.

System: H-DS2-81-44			
Title: Historic - Inward Opening Doorset (44mm)			
Scale:	As Shown	Rev No: A	Date: 15-Mar-18
Drawn By:	LH	Sheet No: 2	Status: Released

GEORGE BARNSDALE
Est. 1884
High Street, Donington, Spalding, Lincs, PE11 4TA
01775 823000
www.georgebarnsdale.co.uk

FRAME OPTIONS

Frame and SashOptions - (Scale 1:2)

81mm Frame - Standard Profile

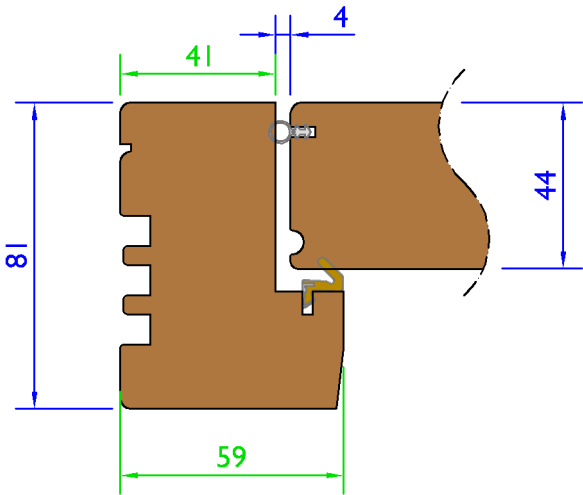

81mm Frame - Pencil Round Profile

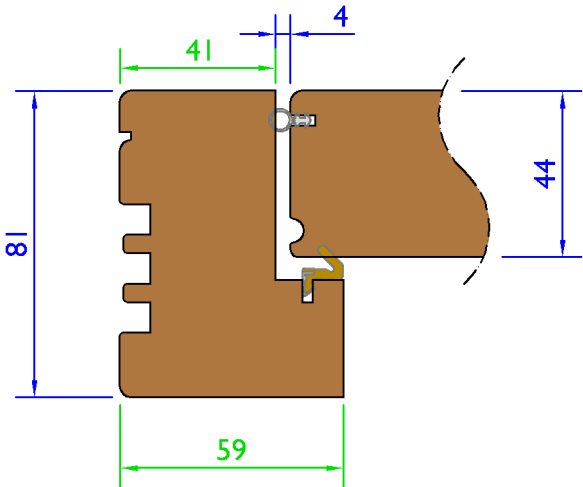

Cill Extension Options - (Scale 1:2)

Cill Extension For 30 mm Extension

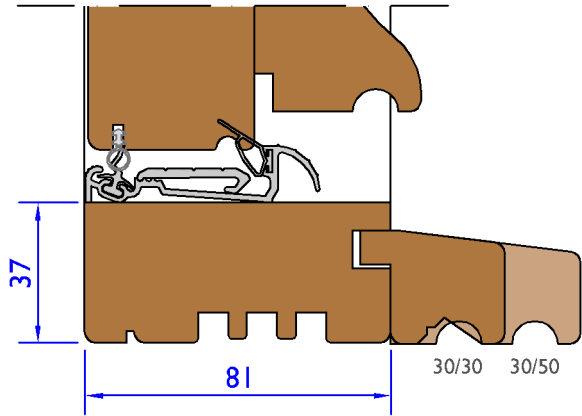

Cill Extension For 35 mm Extension

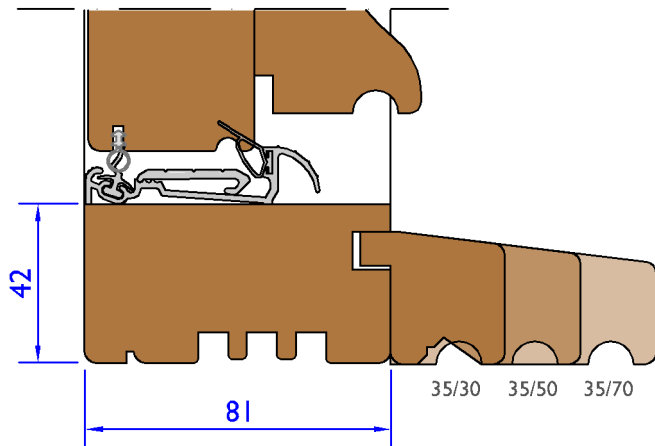

Cill Extension For 45 mm Extension

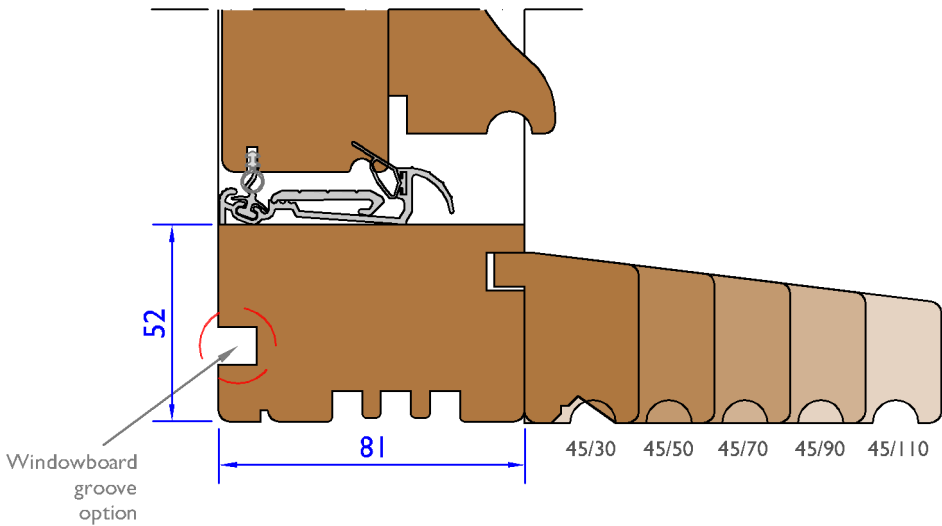

Low Threshold Options - (Scale 1:2)

Low Threshold Cill Option 1 - (Scale 1:2)

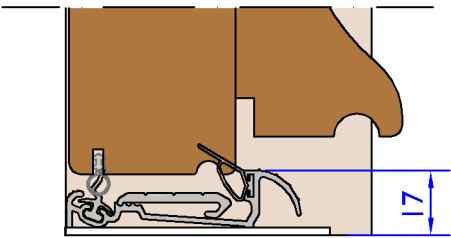

Not Part M compliant

High performance Cill Option 2 - (Scale 1:2)

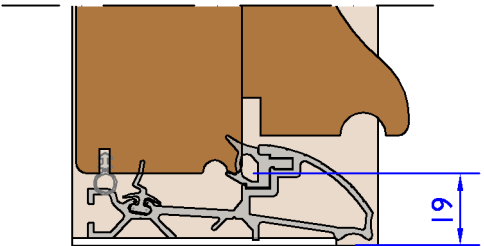

Not Part M compliant

Low Threshold Cill Option 3 - (Scale 1:2)

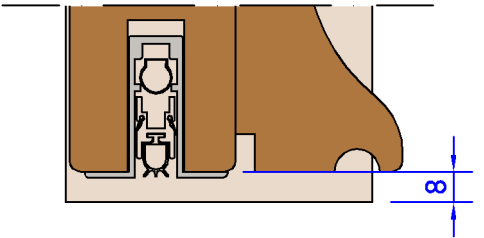

Reduced weather performance

Variable Dimensions
(Dim shown is usually min)

Fixed Dimensions

Tolerances: All tolerances are to George Barnsdale Standard Tolerance definitions (see supporting document for more detail) unless stated on the drawing.
© George Barnsdale & Sons Ltd. All rights reserved. No part of this drawing may be reproduced without the permission of George Barnsdale & Son Ltd.

System: H-DS2-81-44		
Title: Historic - Inward Opening Doorset (44mm)		
Scale:	As Shown	Rev No: A
Drawn By:	LH	Sheet No: 3
		Date: 15-Mar-18
		Status: Released

French Doors - Outside View (Scale 1:20)

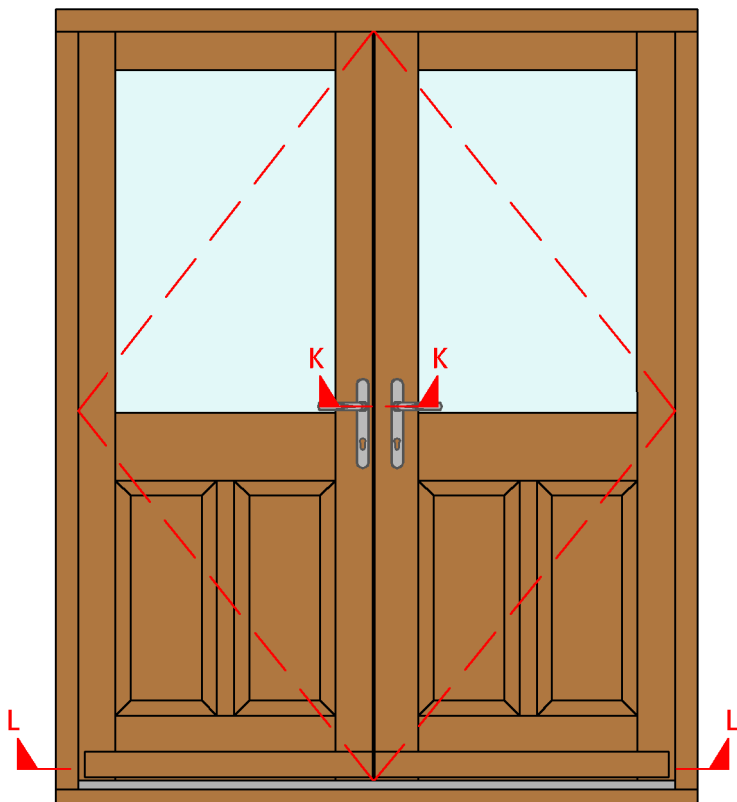

Section L-L - Timber Weather Bar Fitting - (Scale 1:2)

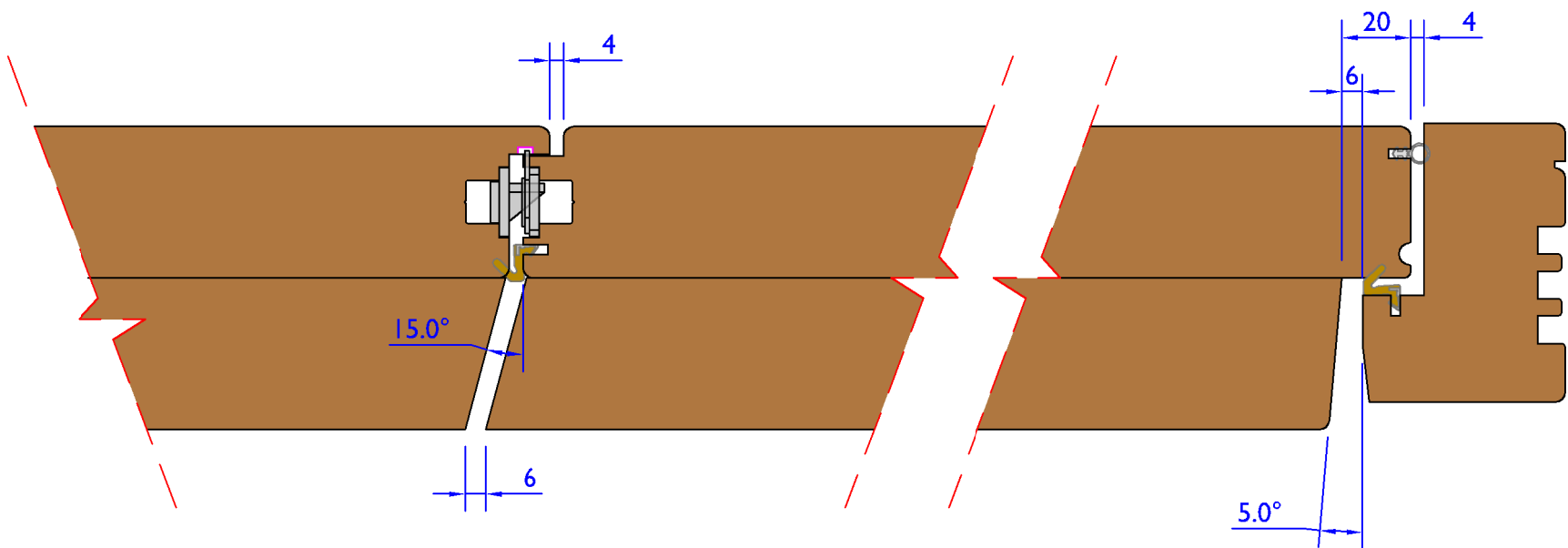

Section K-K - French Meeting Rail Options
French Door Meeting Concealed Lock Option - (Scale 1:2)

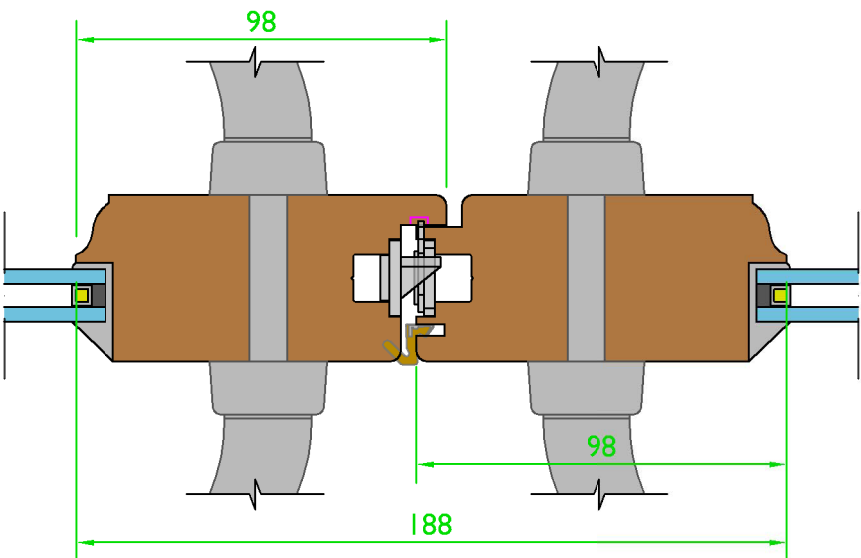

French Door Meeting - (Scale 1:2)

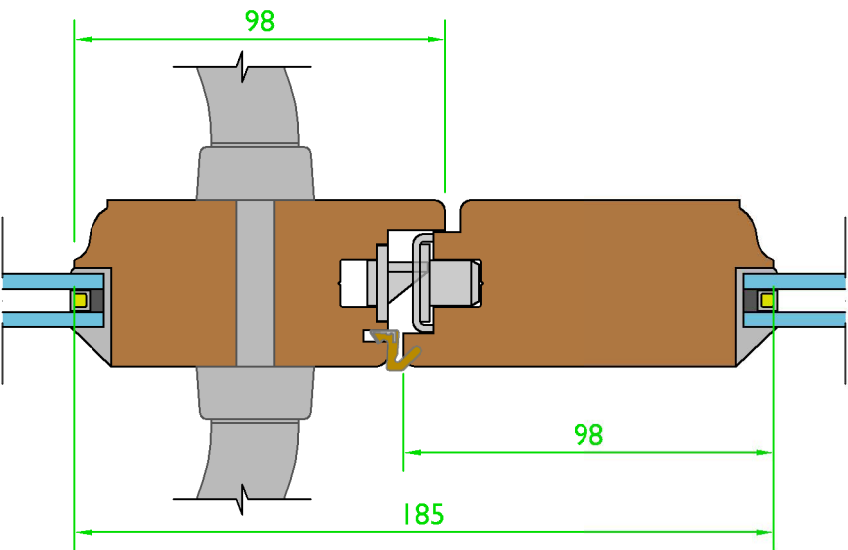

Thumb Bolt Lock Option - (Scale 1:2)

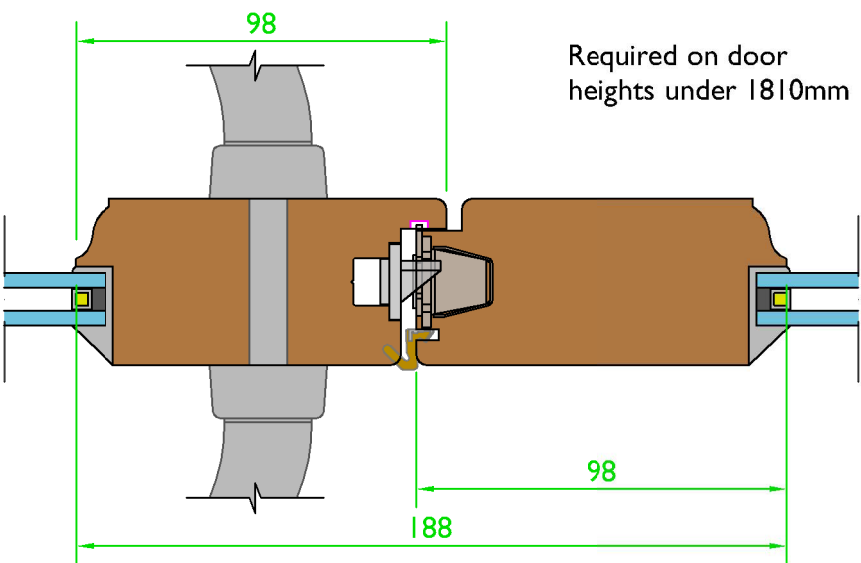

Tolerances: All tolerances are to George Barnsdale Standard Tolerance definitions (see supporting document for more detail) unless stated on the drawing.
© George Barnsdal: & Sons Ltd. All rights reserved. No part of this drawing may be reproduced without the permission of George Barnsdale & Son Ltd.

Variable Dimensions
(Dim shown is usually min)

Fixed Dimensions

System: H-DS2-81-44			
Title: Historic - Inward Opening Doorset (44mm)			
Scale:	As Shown	Rev No:	A
Drawn By:	LH	Sheet No:	4
		Date:	15-Mar-18
		Status:	Released

GEORGE
BARNSDALE
Est. 1884
High Street, Donington, Spalding, Lincs, PE11 4TA
01775 823000
www.georgebarnsdale.co.uk

VENTILATION OPTION DETAILS

Frame With Head Drip Option - (Scale 1:2)

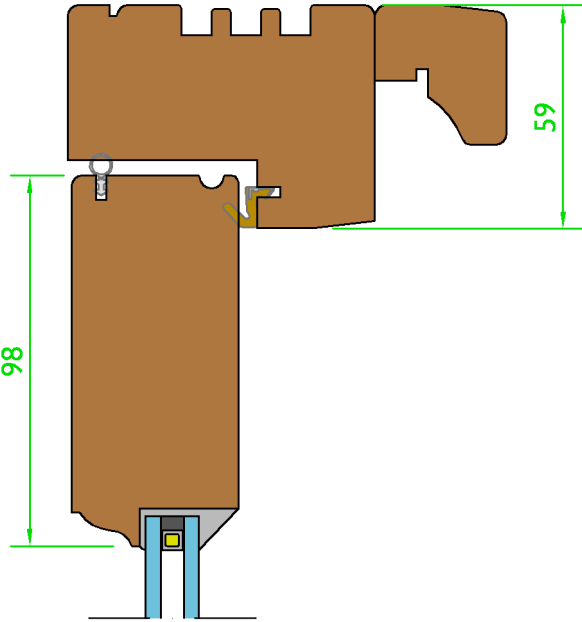

Frame Vent Option (Slide In/Grille Out) - (Scale 1:2)

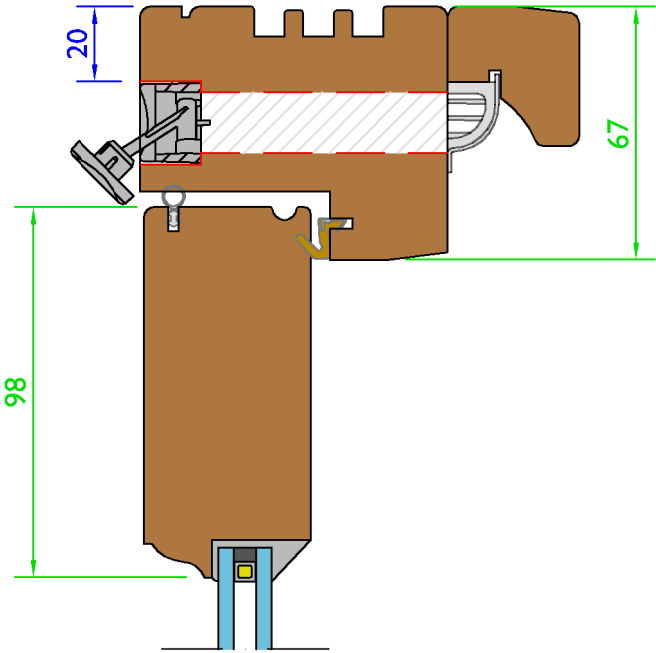

Frame Vent Option (Slide In/Canopy Out) - (Scale 1:2)

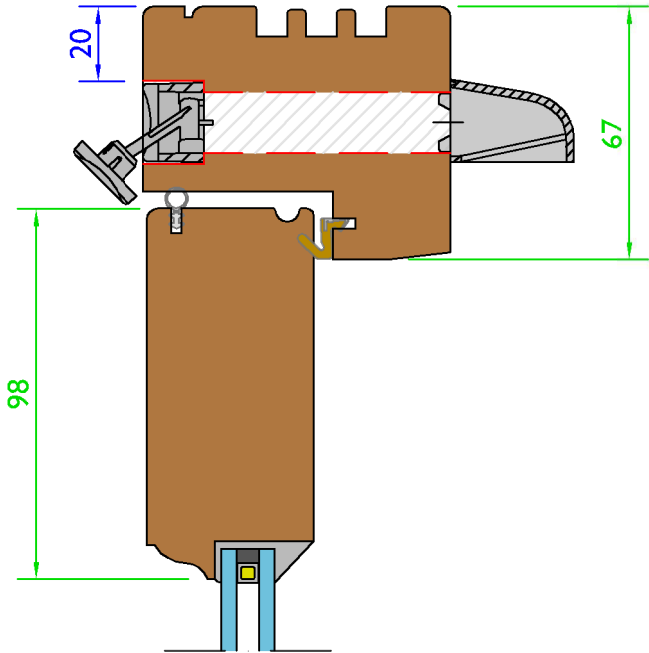

Sash Vent Option (Slide In/Canopy Out) - (Scale 1:2)

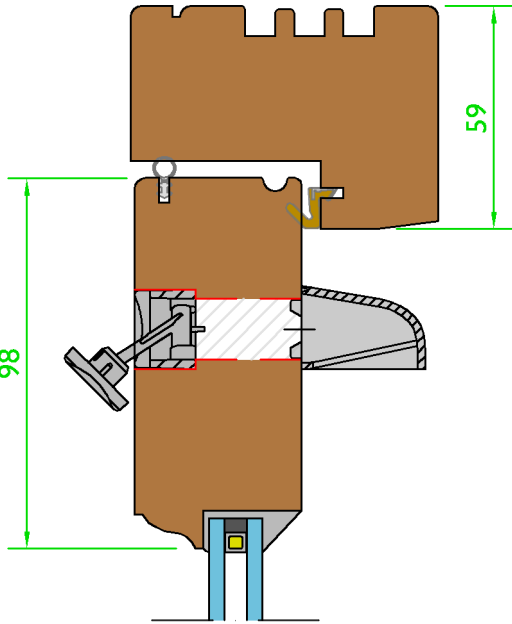

 Vent System

 Variable Dimensions
(Dim shown is usually min)

 Fixed Dimensions

Tolerances: All tolerances are to George Barnsdale Standard Tolerance definitions (see supporting document for more detail) unless stated on the drawing.
© George Barnsdal: & Sons Ltd. All rights reserved. No part of this drawing may be reproduced without the permission of George Barnsdale & Son Ltd.

System: H-DS2-81-44		
Title: Historic - Inward Opening Doorset (44mm)		
Scale:	Rev No:	Date:
As Shown	A	15-Mar-18
Drawn By:	Sheet No:	Status:
LH	5	Released

**GEORGE
BARNSDALE**
Est. 1884
High Street, Donington, Spalding, Lincs, PE11 4TA
01775 823000
www.georgebarnsdale.co.uk

90° Corner Post

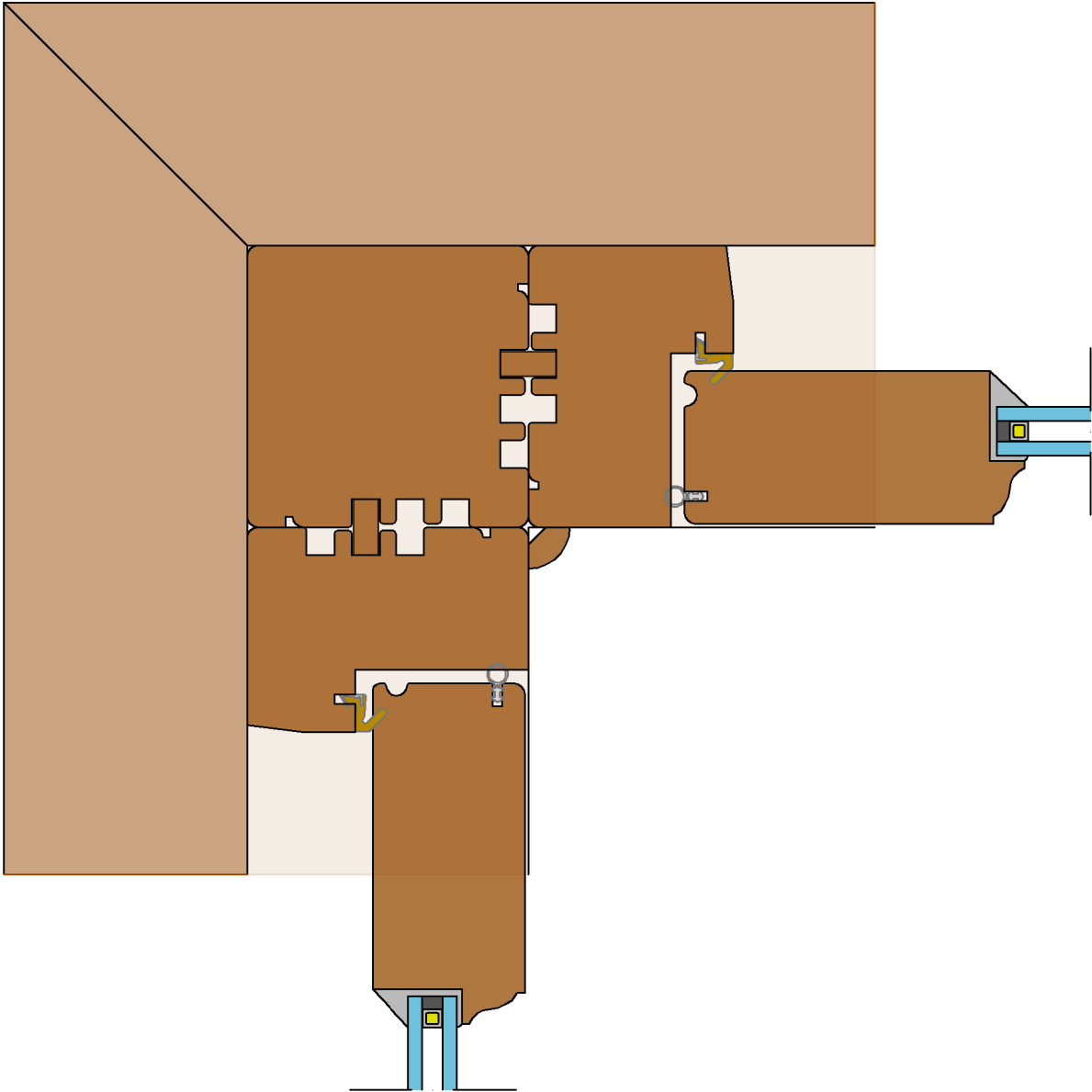

91-155° Angled Corner Post

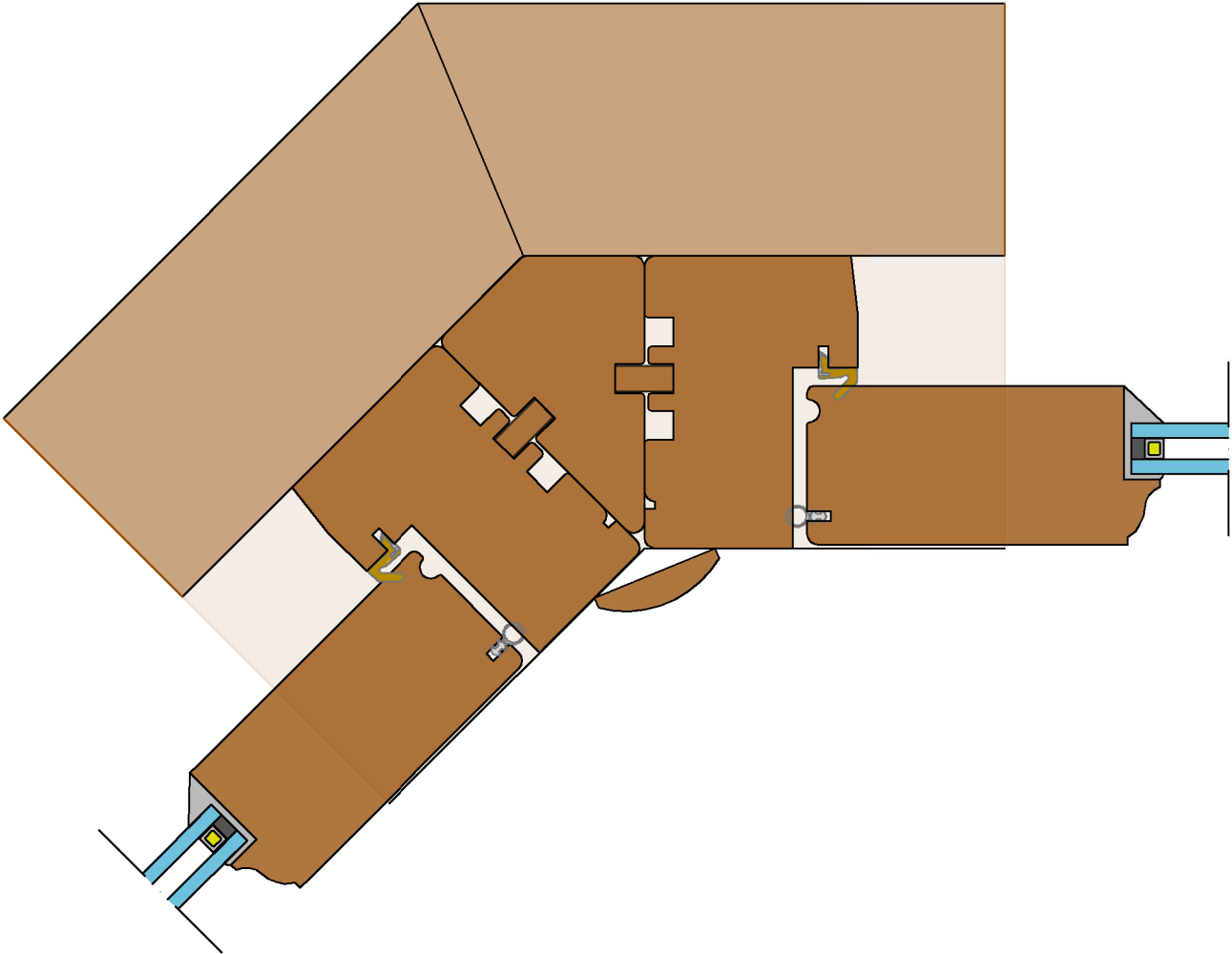

156-179° Segmented Bay

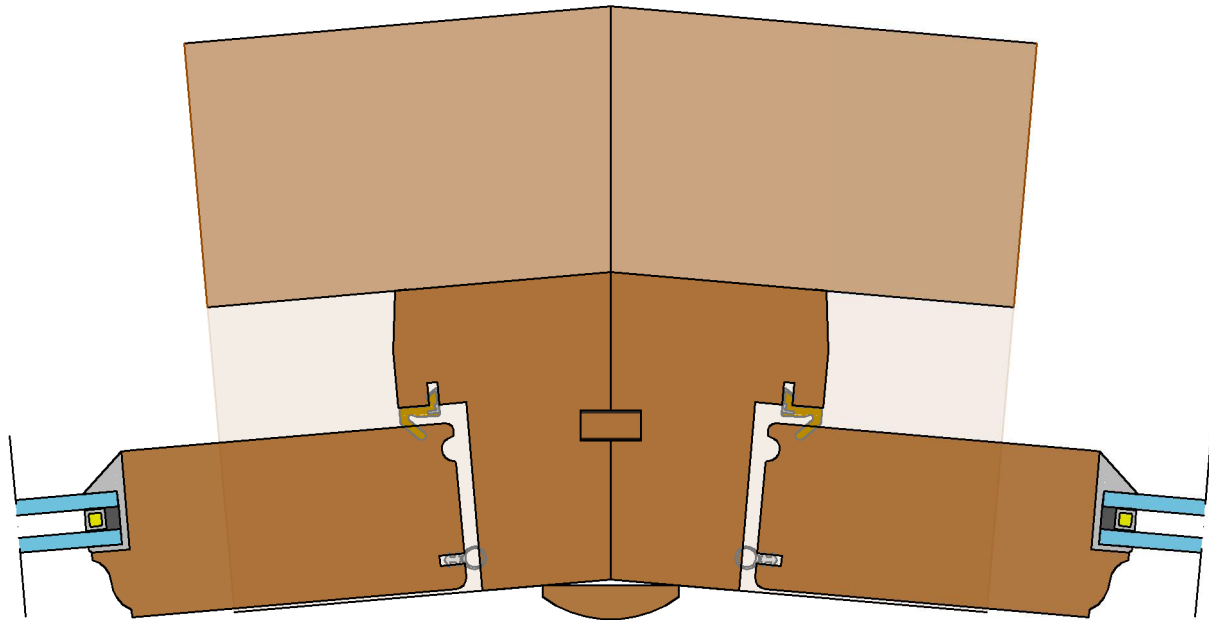

 Vent System

 Variable Dimensions
(Dim shown is usually min)

 Fixed Dimensions

System: H-DS2-81-44			
Title: Historic - Inward Opening Doorset (44mm)			
Scale:	As Shown	Rev No: A	Date: 15-Mar-18
Drawn By:	LH	Sheet No: 6	Status: Released

**GEORGE
BARNSDALE**
Est. 1884
High Street, Donington, Spalding, Lincs, PE11 4TA
01775 823000
www.georgebarnsdale.co.uk

STANDARD DOOR TYPE (Scale 1:30)

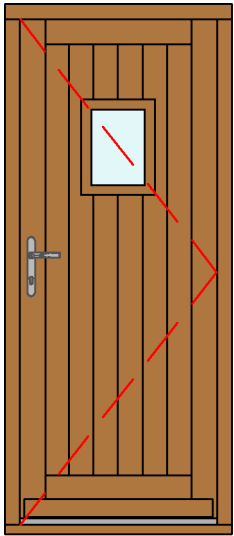

Type 101
(With Vision Panel)

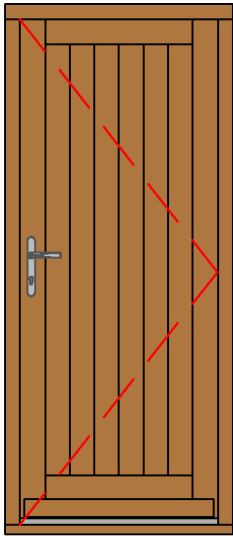

Type 101

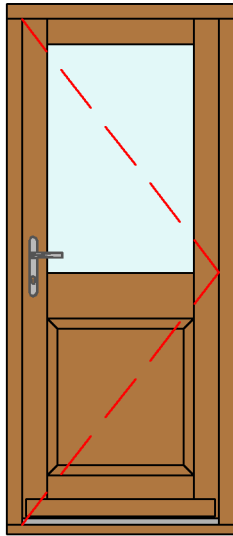

Type 102

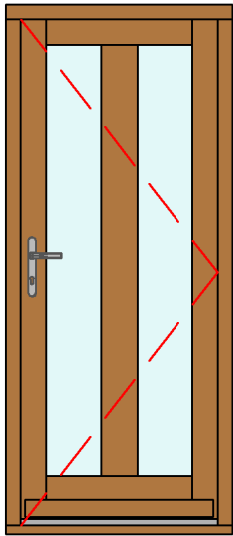

Type 103

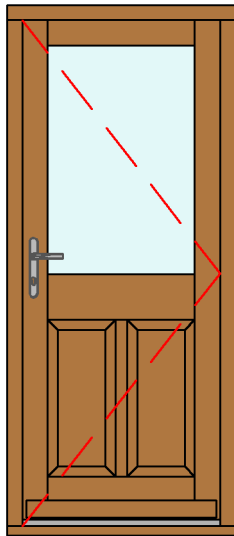

Type 104

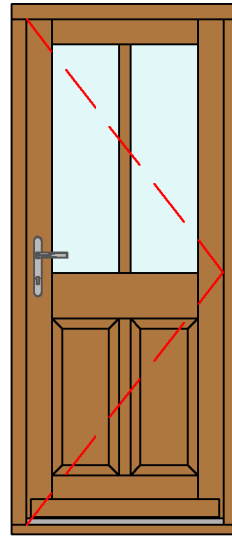

Type 105

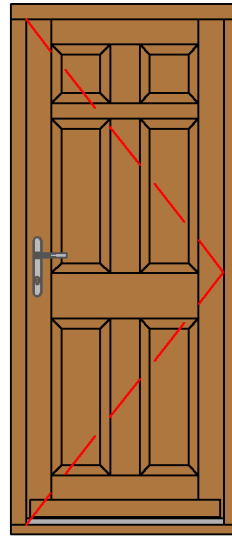

Type 106

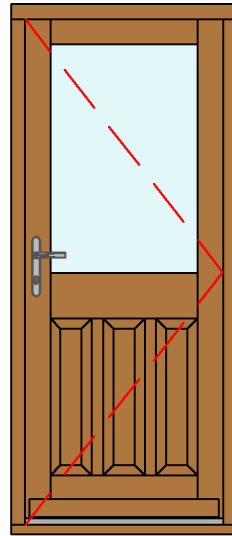

Type 107

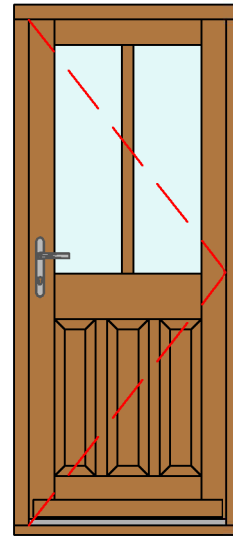

Type 108

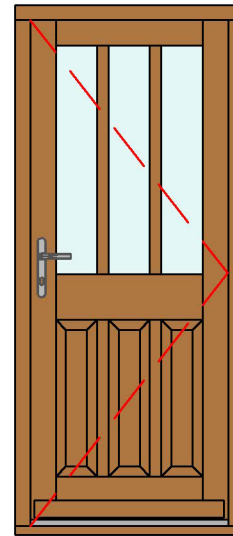

Type 109

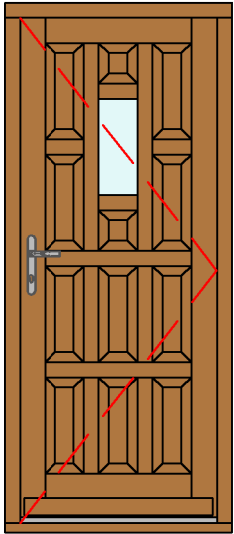

Type 157

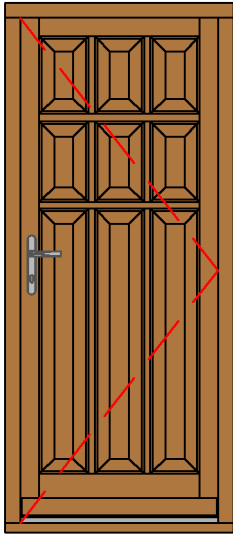

Type 110

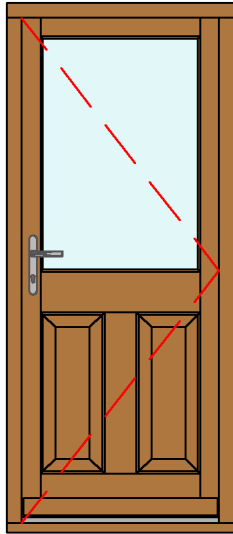

Type 111

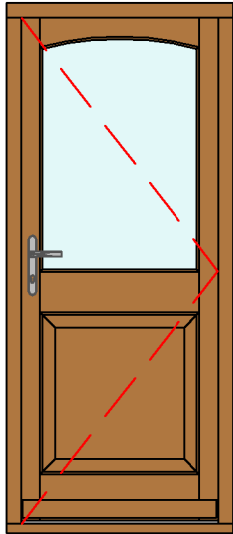

Type 120

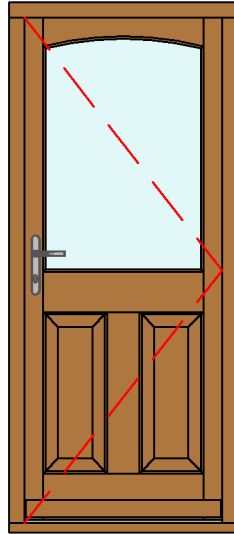

Type 121

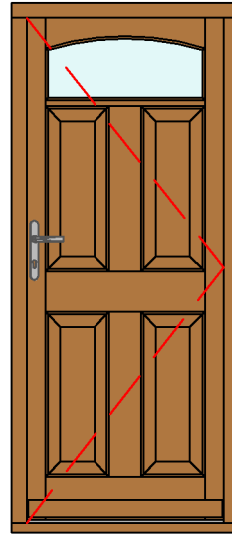

Type 122

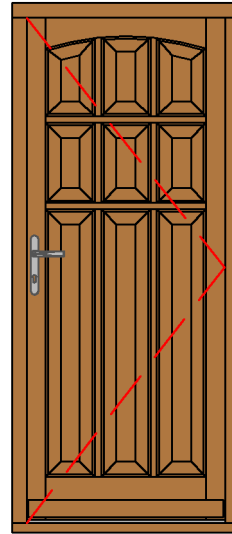

Type 123

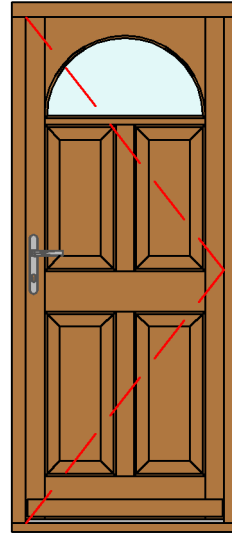

Type 140

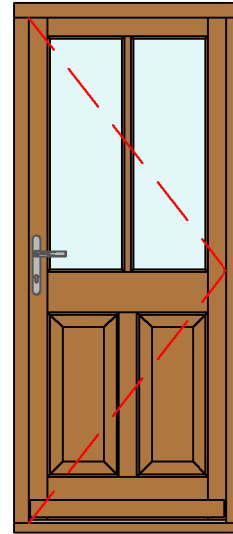

Type 141

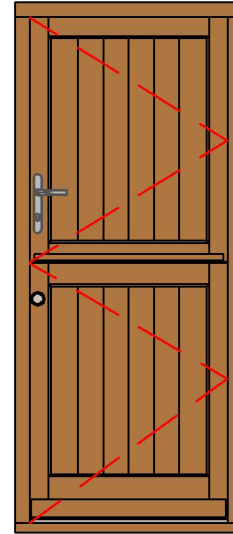

Type Stable

Tolerances: All tolerances are to George Barnsdale Standard Tolerance definitions (see supporting document for more detail) unless stated on the drawing.
© George Barnsdal: & Sons Ltd. All rights reserved. No part of this drawing may be reproduced without the permission of George Barnsdale & Son Ltd.

System: H-DS2-81-44		
Title: Historic - Inward Opening Doorset (44mm)		
Scale:	Rev No:	Date:
As Shown	A	15-Mar-18
Drawn By:	Sheet No:	Status:
LH	7	Released

GEORGE
BARNSDALE

Est. 1884

High Street, Donington, Spalding, Lincs, PE11 4TA
01775 823000
www.georgebarnsdale.co.uk

STANDARD DOOR TYPE (Scale 1:40)

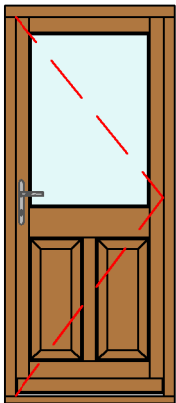

Type L101

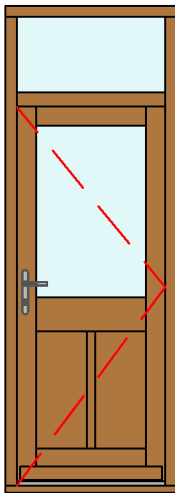

Type L102

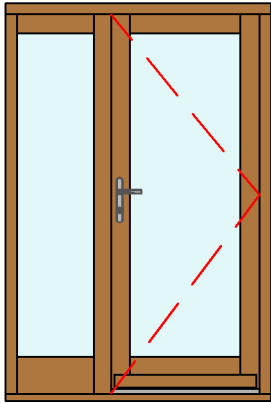

Type L201

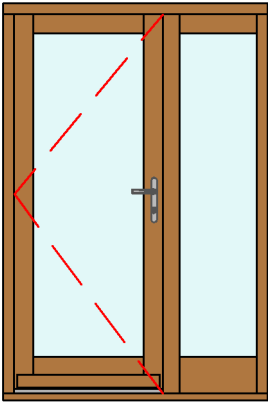

Type L202

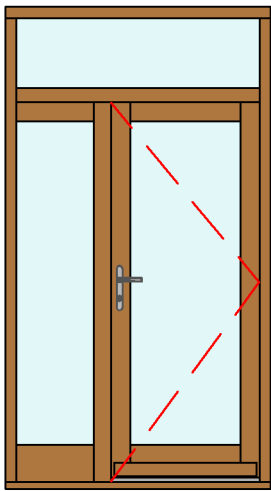

Type L203

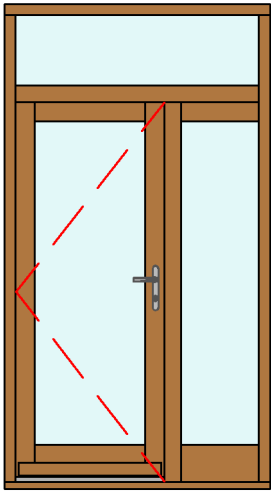

Type L204

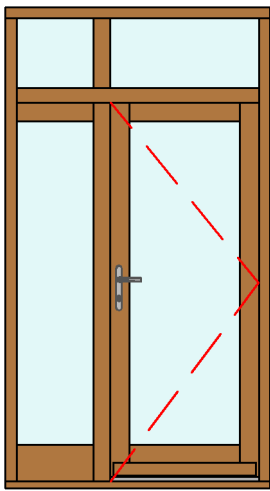

Type L205

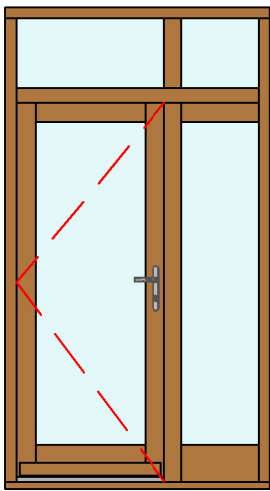

Type L206

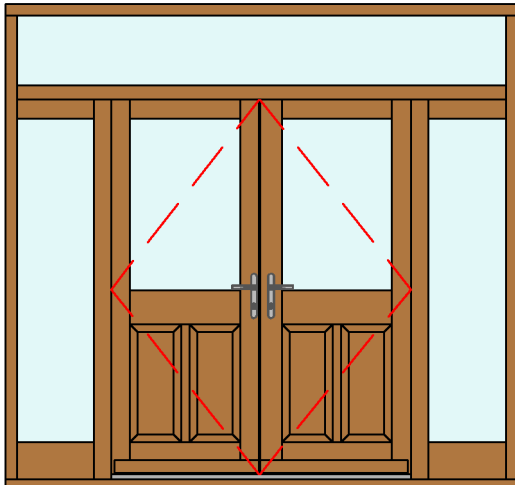

French Doors With Sideligths and Fanlight

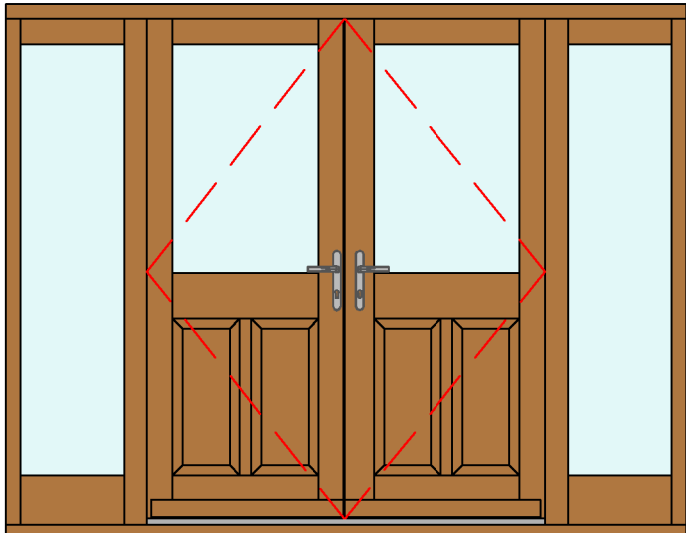

French Doors With Sidelights

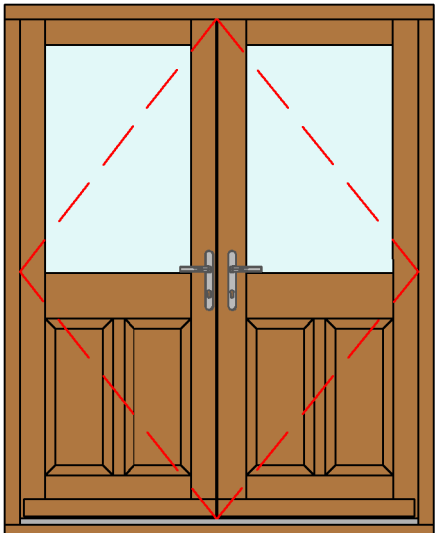

French Doors

Tolerances: All tolerances are to George Barnsdale Standard Tolerance definitions (see supporting document for more detail) unless stated on the drawing.
© George Barnsdal: & Sons Ltd. All rights reserved. No part of this drawing may be reproduced without the permission of George Barnsdale & Son Ltd.

System: H-DS2-81-44		
Title: Historic - Inward Opening Doorset (44mm)		
Scale:	Rev No:	Date:
As Shown	A	15-Mar-18
Drawn By:	Sheet No:	Status:
LH	8	Released